

FOR LEASE

Unit B-2030 Notre Dame Avenue

Industrial Space in CentrePort

Tyson Preisentanz
Senior Vice President

T 204 928 5002
C 204 782 6183
tyson.preisentanz@cwstevenson.ca

Ryan Munt
Senior Vice President

T 204 928 5015
C 204 298 1905
ryan.munt@cwstevenson.ca



**CUSHMAN &
WAKEFIELD**
Winnipeg



Stevenson

FOR LEASE

Unit B-2030 Notre Dame



(+/-) 32,253 sf Available

PROPERTY HIGHLIGHTS

- Warehouse/distribution space located in CentrePort Canada
- Great access to major transportation routes with close proximity to Route 90
- 30' x 50' column spacing
- (+/-) 19' - 21.5' ceiling height
- (4) 8' x 10' dock doors with levelers
- Ample parking on-site
- Fully sprinklered
- Zoned M2

Lease Rate: \$7.75 psf Net
CAM & Tax: \$3.87 psf (2021 est.)



FOR LEASE

B-2030 Notre Dame Ave

FLOOR PLAN

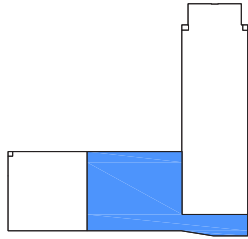

KEY PLAN

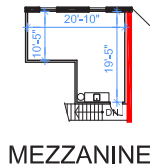

MEZZANINE

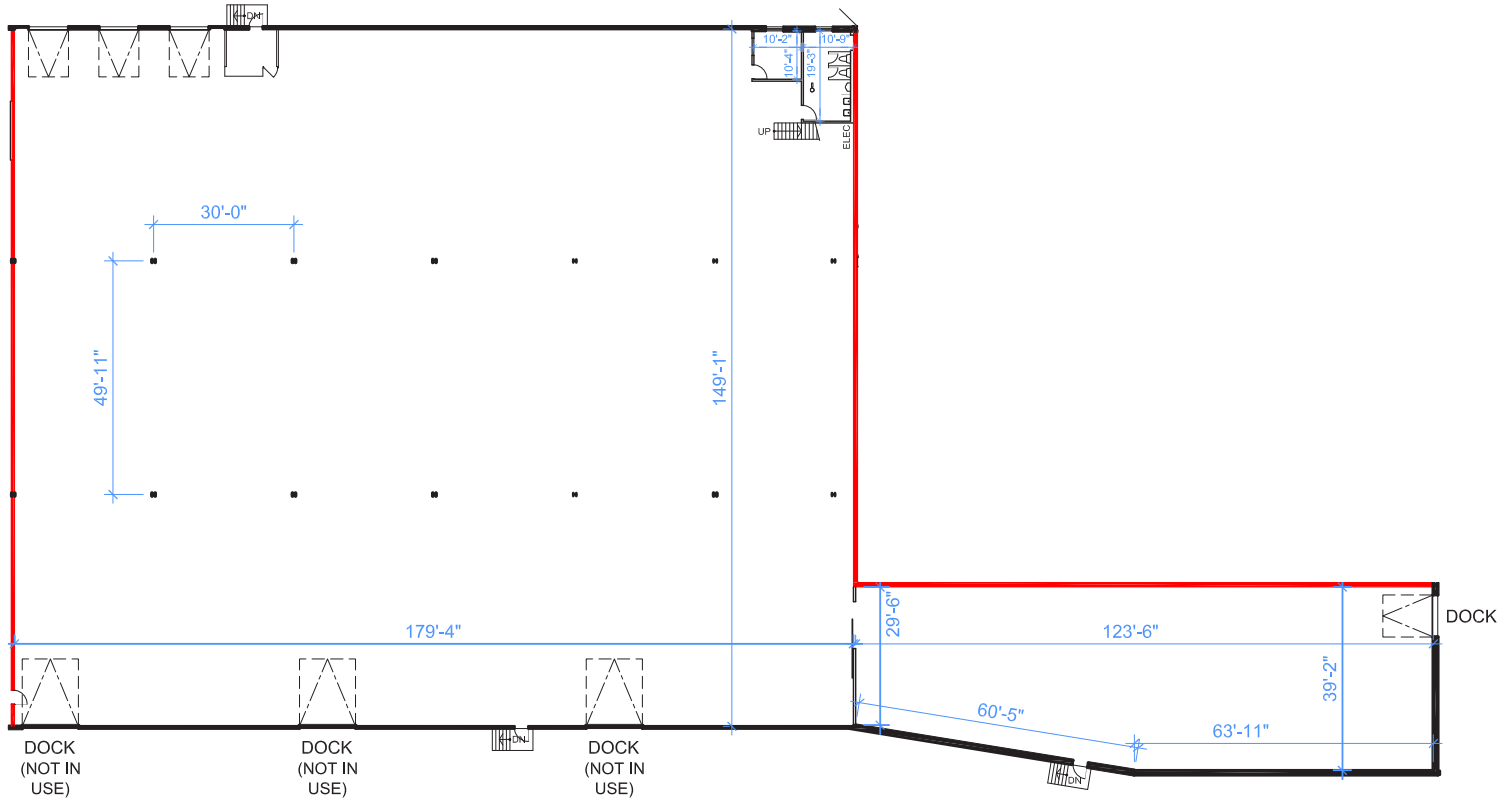

FOR LEASE

B-2030 Notre Dame Ave

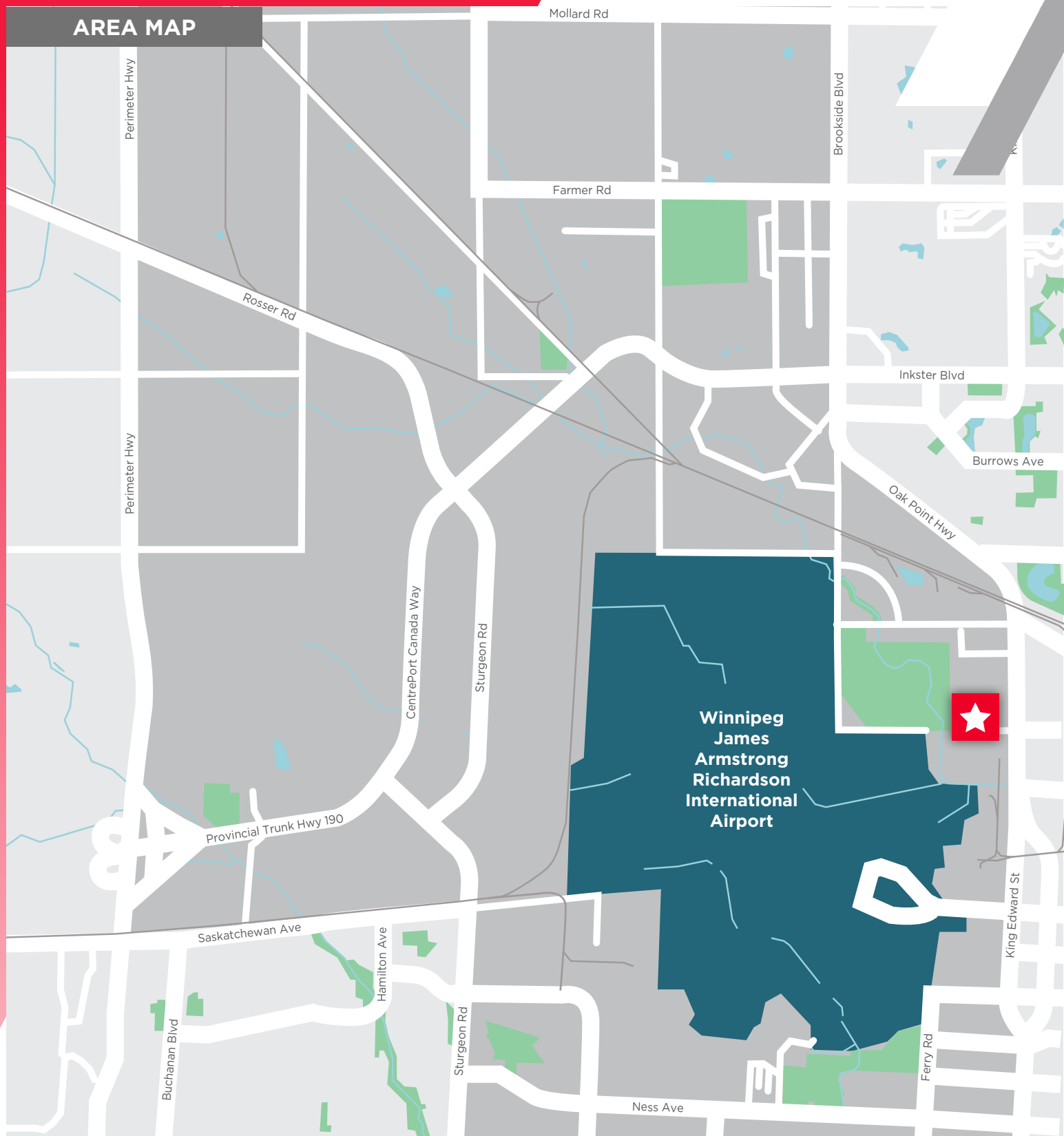

Tyson Preisentanz
Senior Vice President

T 204 928 5002

C 204 782 6183

tyson.preisentanz@cwstevenson.ca

Ryan Munt
Senior Vice President

T 204 928 5015

C 204 298 1905

ryan.munt@cwstevenson.ca

Independently Owned and Operated / A Member of the Cushman & Wakefield Alliance ©2021 Cushman & Wakefield. All rights reserved.
The information contained in this communication is strictly confidential.

This information has been obtained from sources believed to be reliable but has not been verified. NO WARRANTY OR REPRESENTATION, EXPRESS OR IMPLIED, IS MADE AS TO THE CONDITION OF THE PROPERTY (OR PROPERTIES) REFERENCED HEREIN OR AS TO THE ACCURACY OR COMPLETENESS OF THE INFORMATION CONTAINED HEREIN, AND SAME IS SUBMITTED SUBJECT TO ERRORS, OMISSIONS, CHANGE OF PRICE, RENTAL OR OTHER CONDITIONS, WITHDRAWAL WITHOUT NOTICE, AND TO ANY SPECIAL LISTING CONDITIONS IMPOSED BY THE PROPERTY OWNER(S). ANY PROJECTIONS, OPINIONS OR ESTIMATES ARE SUBJECT TO UNCERTAINTY AND DO NOT SIGNIFY CURRENT OR FUTURE PROPERTY PERFORMANCE.



**CUSHMAN &
WAKEFIELD**
Winnipeg



Stevenson