



CUSHMAN &  
WAKEFIELD  
Winnipeg



Stevenson

FOR LEASE

90-120

Paramount  
Road

Office/Warehouse  
Space Available

**Tyson Preisentanz**  
**Senior Vice President & Principal**  
T 204 928 5002  
C 204 782 6183  
[tyson.preisentanz@cwstevenson.ca](mailto:tyson.preisentanz@cwstevenson.ca)

**Ryan Munt**  
**Senior Vice President**  
T 204 928 5015  
C 204 298 1905  
[ryan.munt@cwstevenson.ca](mailto:ryan.munt@cwstevenson.ca)

**FOR LEASE**

# 90-120 Paramount Rd

(+/-) 2,021 sf and (+/-) 2,684 sf available

## PROPERTY HIGHLIGHTS

- Located in Inkster Park, one block north of Inkster Boulevard in Northwest Winnipeg
- Within close proximity to major transportation corridors
- Brick facade with glazed storefronts
- Unit 110 has one grade door
- Ample parking on-site
- Zoned M2 - Industrial

ADDRESS	SQ. FT. (+/-)	LEASE RATE	ADDITIONAL RENT	AVAILABILITY
98	2,021	\$7.95 psf	\$4.35 psf (2022 est.)	Immediately
110	2,684	\$8.50 psf	\$4.35 psf (2022 est.)	October 1, 2022



FOR LEASE



# 90-120 Paramount Road

## SITE PLAN

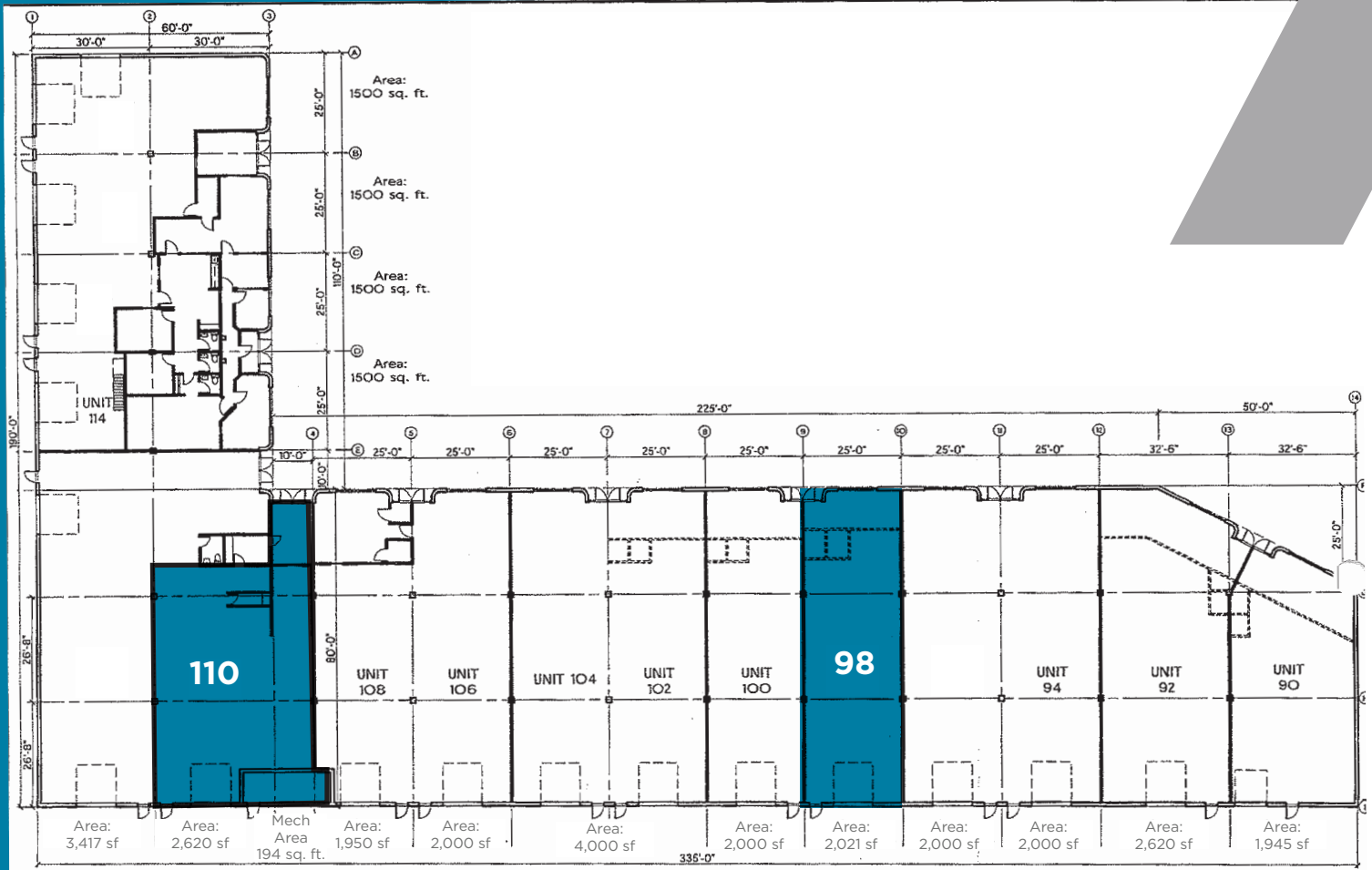

FOR LEASE



# 90-120 Paramount Road

## AREA MAP





**Tyson Preisentanz**  
**Senior Vice President & Principal**  
T 204 928 5002  
C 204 782 6183  
tyson.preisentanz@cwstevenson.ca

**Ryan Munt**  
**Senior Vice President**  
T 204 928 5015  
C 204 298 1905  
ryan.munt@cwstevenson.ca



Pure Industrial is one of Canada's leading providers of industrial real estate. Headquartered in Toronto, with offices in Montreal, Quebec City, and Vancouver, Pure Industrial owns and operates a portfolio of over 41 million square feet of high-quality and well-located assets, ranging from small warehouses to large industrial developments.

Our strategic focus has enabled us to develop and refine our unique industrial real estate offering in order to serve the needs of customers, with premium industrial real estate in locations that are critical for the Canadian supply chain, from the first mile, to the last.

Pure prides itself on its professional and customer service-oriented team, building long-term relationships with tenants based on providing highly-responsive, personalized service.



Independently Owned and Operated / A Member of the Cushman & Wakefield Alliance ©2022 Cushman & Wakefield. All rights reserved. The information contained in this communication is strictly confidential.

This information has been obtained from sources believed to be reliable but has not been verified.

NO WARRANTY OR REPRESENTATION, EXPRESS OR IMPLIED, IS MADE AS TO THE CONDITION OF THE PROPERTY (OR PROPERTIES) REFERENCED HEREIN OR AS TO THE ACCURACY OR COMPLETENESS OF THE INFORMATION CONTAINED HEREIN, AND SAME IS SUBMITTED SUBJECT TO ERRORS, OMISSIONS, CHANGE OF PRICE, RENTAL OR OTHER CONDITIONS, WITHDRAWAL WITHOUT NOTICE, AND TO ANY SPECIAL LISTING CONDITIONS IMPOSED BY THE PROPERTY OWNER(S). ANY PROJECTIONS, OPINIONS OR ESTIMATES ARE SUBJECT TO UNCERTAINTY AND DO NOT SIGNIFY CURRENT OR FUTURE PROPERTY PERFORMANCE.